

## FRONT FENDER PANEL (B TYPE)

### REMOVAL AND INSTALLATION

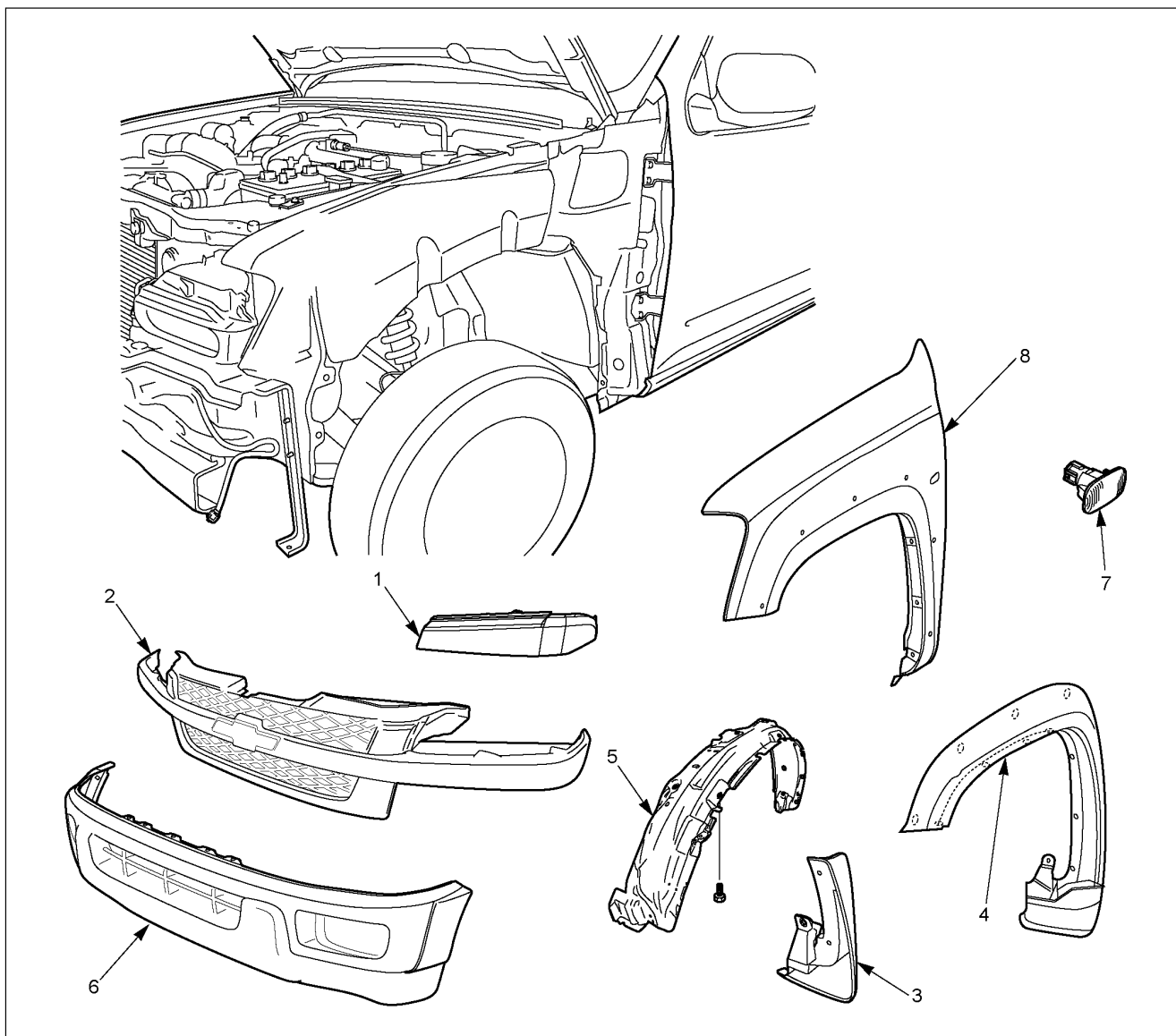

RTW52BLF000101

### Removal Steps

- ▲ 1. Front combi lamp assembly
- ▲ 2. Radiator grille
- ▲ 3. Mud guard (W/O front wheel extension)
- ▲ 4. Front wheel extension (W/ front wheel extension)
- ▲ 5. Inner liner
- ▲ 6. Front bumper fascia
- ▲ 7. Side turn signal light
- ▲ 8. Front fender panel

### Installation Steps

- ▲ 8. Front fender panel
- ▲ 7. Side turn signal light
- ▲ 6. Front bumper fascia
- ▲ 5. Inner liner
- ▲ 4. Front wheel extension (W/ front wheel extension)
- ▲ 3. Mud guard (W/O front wheel extension)
- ▲ 2. Radiator grille
- ▲ 1. Front combi lamp assembly